

RYDS LANE

College Extension = 128 sq.m on first floor

Community Extension = 25 sq.m on first floor (including void)

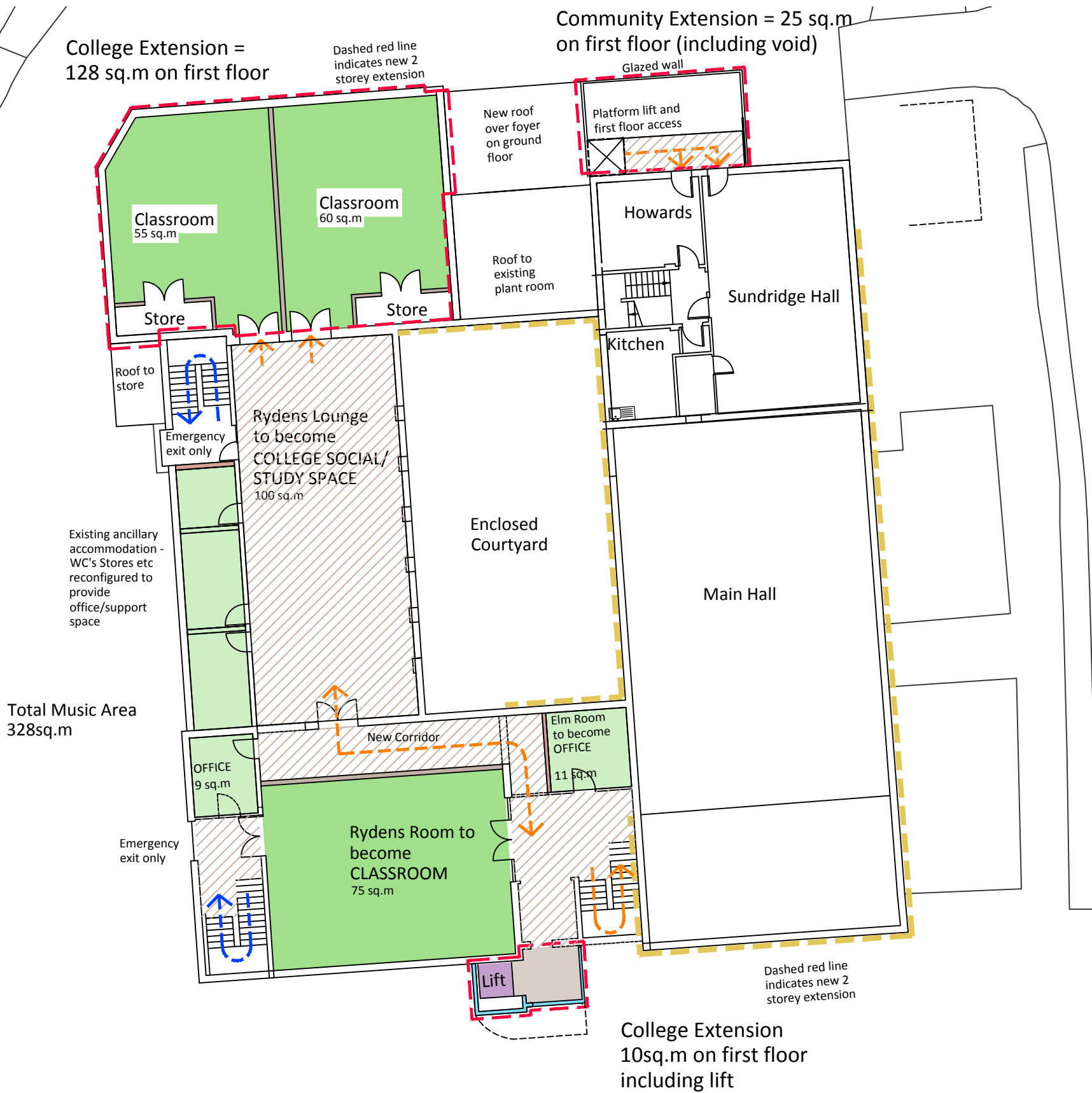

Total Music Area 328sq.m

College Extension 10sq.m on first floor including lift

Revision	Notes/key
-	-
-	-
-	-
-	-



Ordnance Survey, (c) Crown Copyright 2015. All rights reserved. Licence number 000000000  
 This drawing copyright of Macallan Penfold Ltd, and must not be copied, altered or reproduced in any way or passed on to a third party without written authority. All dimensions subject to site survey and verification. Not to be scaled for construction purposes.



Macallan Penfold Ltd, The Barn, 23b High Street, Alton, Hampshire, GU34 1AW  
 T: 01252 622619 E: info@macallan-penfold.co.uk W: www.macallan-penfold.co.uk

0m 2m 4m 6m 8m 10m 12m	
Scale	Date
1:200 at A3	-
Drawn	Checked
-	-

Client		
Woking Borough Council		
Project		
Old Woking Community Hall Feasibility Study 3		
Drawing Title		
Proposed First Floor Plan		
Project Number	Drawing Number	Revision
1317	P.011	-